

ACCESS ARCHITECTURAL HARDWARE

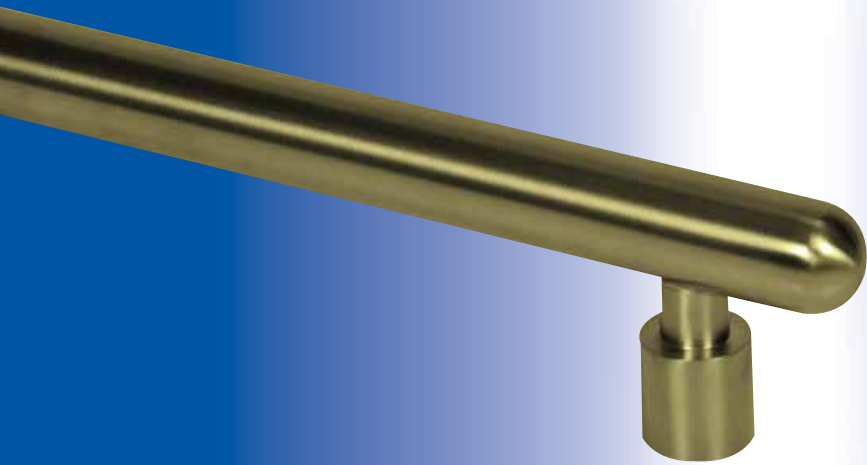

ACCESS DOOR
www.accessdoor.us

ARCHITECTURAL PUSH-PULL HARDWARE

ACCESS ARCHITECTURAL HARDWARE



Access Architectural Hardware is a US Company located in the heartland of America. We have over 75 years of experience manufacturing and supplying premium quality architectural push pull hardware and other hardware designed to be used in the commercial door, glass and aluminum industry.

We possess an extensive manufacturing facility with bending, welding, metal finishing, and CNC machining capabilities. We pride ourselves on our ability to interpret, design and fabricate a wide variety of custom architectural handles and related products. We have developed a reputation within our industry for providing high quality products at competitive prices and lead times that meet our customer's requirements.

Access Architectural Hardware is the exclusive manufacturer of "Smart Touch" and "Smart Grip" exit devices for all glass and framed door applications.



Access Architectural Hardware

(319) 208-7822 • Fax (319) 208-7708 • www.aahardware.us

AA1000 SERIES

(WIRE PULLS, AND PUSH BARS)

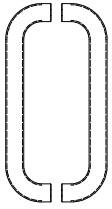

AA1100 Series 1" Diameter			
Part #	Material	Projection	C. to C.
AA1110	1.00" Dia.	2-1/2"	10"
AA1112	1.00" Dia.	2-1/2"	12"
AA1100	1.00" Dia.	Specify	Specify

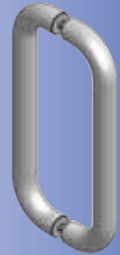

AA1200 Series 1-1/4" Diameter			
Part #	Material	Projection	C. to C.
AA1210	1.25" Dia.	3.00"	10"
AA1212	1.25" Dia.	3.00"	12"
AA1200	1.25" Dia.	Specify	Specify

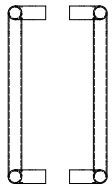

AA1300 Series 1" Offset Pulls			
Part #	Material	Projection	C. to C.
AA1310	1.00" Dia.	2-3/4"	10"
AA1312	1.00" Dia.	2-3/4"	12"
AA1300	1.00" Dia.	Specify	Specify



AA1400 Series 1-1/4" Offset Pulls			
Part #	Material	Projection	C. to C.
AA1410	1.25" Dia.	3.00"	10"
AA1412	1.25" Dia.	3.00"	12"
AA1400	1.25" Dia.	Specify	Specify

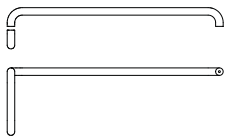

AA1500 Push Pull Combination Sets			
Part #	Material	Pull C. to C.	Push C. to C.
AA1500	1.00" Dia.	Specify	Specify
AA1550	1.25" Dia.	Specify	Specify

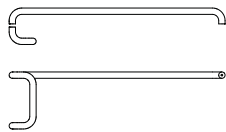
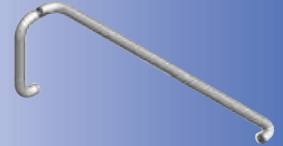

AA1600 Push Pull Combination Sets			
Part #	Material	Pull C. to C.	Push C. to C.
AA1600	1.00" Dia.	Specify	Specify
AA1650	1.25" Dia.	Specify	Specify

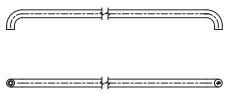
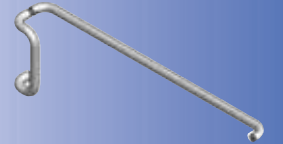

AA1700 Push Bars Solid and Tubular		
Part #	Material	Push C. to C.
AA1710	1.00" Dia.	Specify
AA1720	1.25" Dia.	Specify
AA1730	Specify	Specify



The contemporary 1" diameter series is the current industry standard and is available both in tubular and solid material in all architectural finishes. The 1-1/4" diameter push and pull handles are manufactured from 16 gauge tubular material and while being more substantial in size they still provide the same contemporary appearance as the 1" diameter series.

Both the 1" diameter and 1-1/4" diameter series are available in a split finish.

AA2000 SERIES

(LADDER PULLS)



AA2100 Series			
Part #	Material	Base	Length
AA2110	1.00" Dia.	1.00" Dia.	Specify
AA2120	1.25" Dia.	1.25" Dia.	Specify
AA2130	1.50" Dia.	1.25" Dia.	Specify

AA2200 Series			
Part #	Material	Base	Length
AA2210	1.00" Dia.	1.00" Dia.	Specify
AA2220	1.25" Dia.	1.25" Dia.	Specify
AA2230	1.50" Dia.	1.25" Dia.	Specify

AA2300 Series			
Part #	Material	Base	Length
AA2310	1.00" Dia.	1.00" Dia.	Specify
AA2320	1.25" Dia.	1.25" Dia.	Specify
AA2330	1.50" Dia.	1.25" Dia.	Specify

AA2400 Series			
Part #	Material	Base	Length
AA2410	1.00" Dia.	1.00" Dia.	Specify
AA2420	1.25" Dia.	1.25" Dia.	Specify
AA2430	1.50" Dia.	1.25" Dia.	Specify

AA2500 Series			
Part #	Material	Base	Length
AA2510	1.00" Dia.	1.00" Dia.	Specify
AA2520	1.25" Dia.	1.25" Dia.	Specify
AA2530	1.50" Dia.	1.25" Dia.	Specify

AA2600 Series			
Part #	Material	Base	Length
AA2610	1.00" Dia.	1.00" Dia.	Specify
AA2620	1.25" Dia.	1.25" Dia.	Specify
AA2630	1.50" Dia.	1.50" Dia.	Specify

AA2700 Series			
Part #	Material	Base	Length
AA2710	1.00" Dia.	1.00" Dia.	Specify
AA2720	1.25" Dia.	1.25" Dia.	Specify
AA2730	1.50" Dia.	1.50" Dia.	Specify

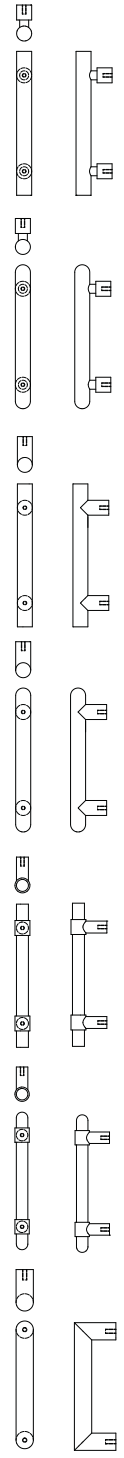

The AA2000 series ladder pulls are available in a variety of styles, sizes and finishes. These contemporary pulls can be manufactured in a split finish which adds an elegant contrast to almost any style of pull. Access Architectural Hardware highly recommends that a center mounting post be added to bars 60" on center or greater. Mounting options include single sided or back to back mounting on glass, wood or storefront doors.



Access Architectural Hardware
 (319) 208-7822 • Fax (319) 208-7708 • www.aahardware.us

AA3000 SERIES

(OVAL PUSH/PULLS)

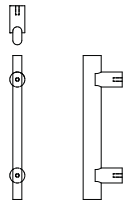

Part #	Material	Length
AA3110	3/4" x 1 1/2" Oval	Specify
AA3120	1" x 1 1/2" Oval	Specify

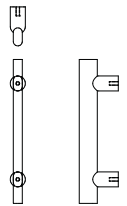

Part #	Material	Length
AA3210	3/4" x 1 1/2" Oval	Specify
AA3220	1" x 1 1/2" Oval	Specify

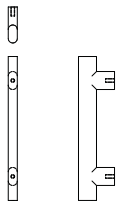

Part #	Material	Length
AA3310	3/4" x 1 1/2" Oval	Specify
AA3320	1" x 1 1/2" Oval	Specify

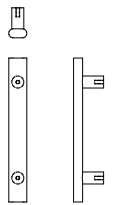

Part #	Material	Length
AA3410	3/4" x 1 1/2" Oval	Specify
AA3420	1" x 1 1/2" Oval	Specify

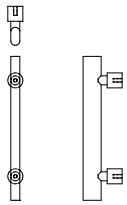

Part #	Material	Length
AA3510	3/4" x 1 1/2" Oval	Specify
AA3520	1" x 1 1/2" Oval	Specify

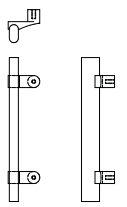

Part #	Material	Length
AA3610	3/4" x 1 1/2" Oval	Specify
AA3620	1" x 1 1/2" Oval	Specify

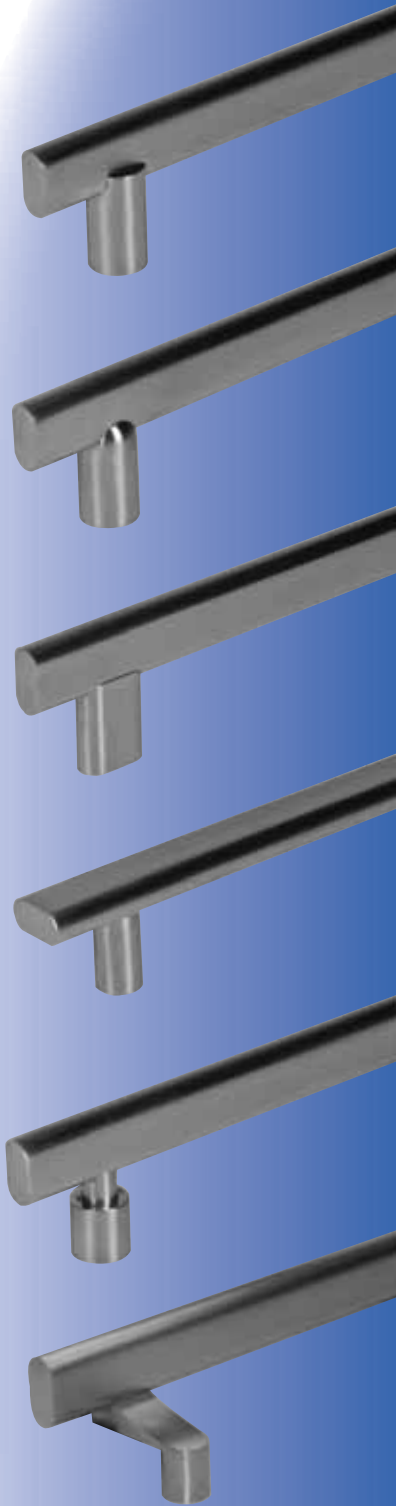

Architectural appeal best describes the AA3000 series of door pulls. The handles are manufactured from oval material which provides a comfortable grip and will enhance the appearance of any type of door. These handles can be mounted vertically or horizontally and are available with multiple mounting post options. The handles are available in a variety of finishes as well as the popular split finish. Access Architectural Hardware highly recommends that a center mounting post be added to bars 60" on center or greater.

AA4000 SERIES

(OFFSET LADDER PULLS)

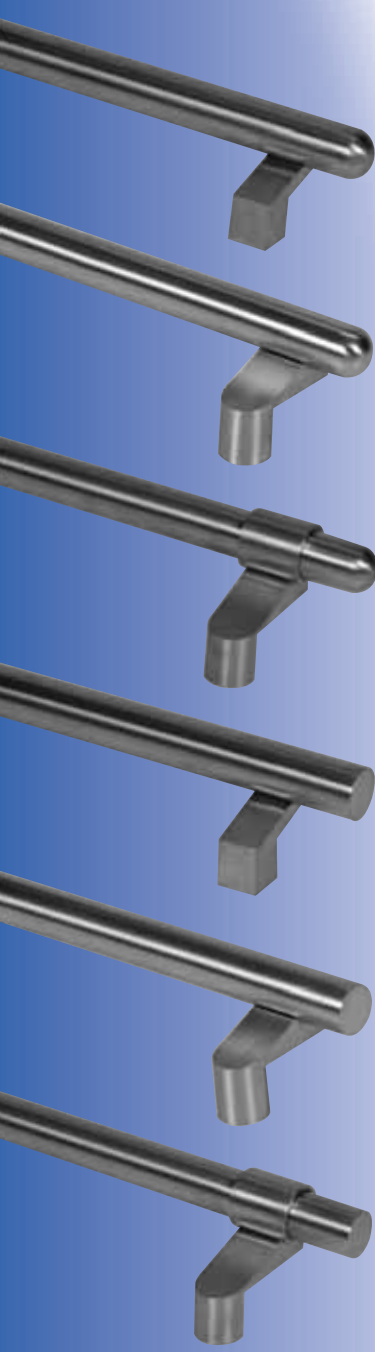

AA4100 Series		
Part #	Material	Length
AA4110	1.00" Dia.	Specify
AA4120	1.25" Dia.	Specify
AA4130	1.50" Dia.	Specify

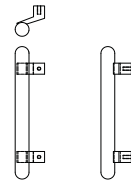

AA4200 Series		
Part #	Material	Length
AA4210	1.00" Dia.	Specify
AA4220	1.25" Dia.	Specify
AA4230	1.50" Dia.	Specify

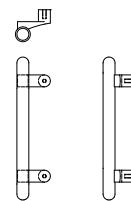

AA4300 Series		
Part #	Material	Length
AA4310	1.00" Dia.	Specify
AA4320	1.25" Dia.	Specify
AA4330	1.50" Dia.	Specify

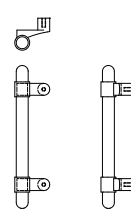

AA4400 Series		
Part #	Material	Length
AA4410	1.00" Dia.	Specify
AA4420	1.25" Dia.	Specify
AA4430	1.50" Dia.	Specify

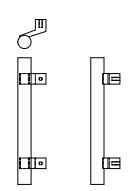

AA4500 Series		
Part #	Material	Length
AA4510	1.00" Dia.	Specify
AA4520	1.25" Dia.	Specify
AA4530	1.50" Dia.	Specify

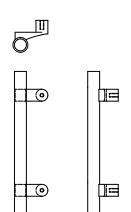

AA4600 Series		
Part #	Material	Length
AA4610	1.00" Dia.	Specify
AA4620	1.25" Dia.	Specify
AA4630	1.50" Dia.	Specify

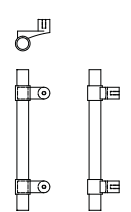

In many cases a cylinder lock or thumb turn may present a problem for a vertically mounted inline pull. There may also be instances where a center mounting post is required on a full length vertical pull mounting on a framed door and drilling a hole in the glass is not an option. With these common conditions in mind Access Architectural Hardware has designed the AA4000 series of offset ladder door pulls. The AA4000 series also aesthetically compliments our AA2000 series of inline ladder pulls. This series is available in a variety of finishes and sizes as well as a split finish. Access Architectural Hardware highly recommends that a center mounting post be added to bars 60" on center or greater.



Access Architectural Hardware

(319) 208-7822 • Fax (319) 208-7708 • www.aahardware.us

AA5000 SERIES

(RADIUS PULLS)

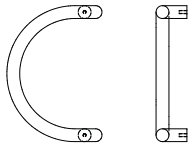

Part

AA5110
AA5120
AA5130
AA5140

AA5100 Series

Material	Length
1.00" Dia.	12"
1.25" Dia.	12"
1.50" Dia.	12"
SPECIFY	SPECIFY

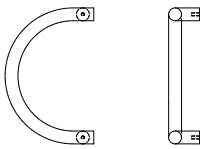

Part

AA5210
AA5220
AA5230
AA5240

AA5200 Series

Material	Length
1.00" Dia.	12"
1.25" Dia.	12"
1.50" Dia.	12"
SPECIFY	SPECIFY

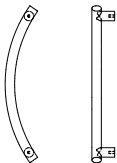

Part

AA5310
AA5320
AA5330
AA5340

AA5300 Series

Material	Length
1.00" Dia.	12"
1.25" Dia.	12"
1.50" Dia.	12"
SPECIFY	SPECIFY



Part

AA5410
AA5420
AA5430
AA5440

AA5400 Series

Material	Length
1.00" Dia.	12"
1.25" Dia.	12"
1.50" Dia.	12"
SPECIFY	SPECIFY

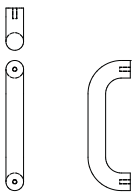

Part

AA5510
AA5520
AA5530

AA5500 Series

Material	Length
1.00" Dia.	Specify
1.25" Dia.	Specify
1.50" Dia.	Specify



The Radius AA5000 series of door pulls is another great example of our diversified manufacturing capabilities. Access Architectural Hardware has the capability to produce a wide assortment of radius pulls ranging from semi-circular to arched designs in various diameters, radii, and finishes. This series is available with a split finish. Access Architectural Hardware highly recommends that a center mounting post be added to bars 60" on center or greater.

AA6000 SERIES

(RECTANGULAR PULLS)

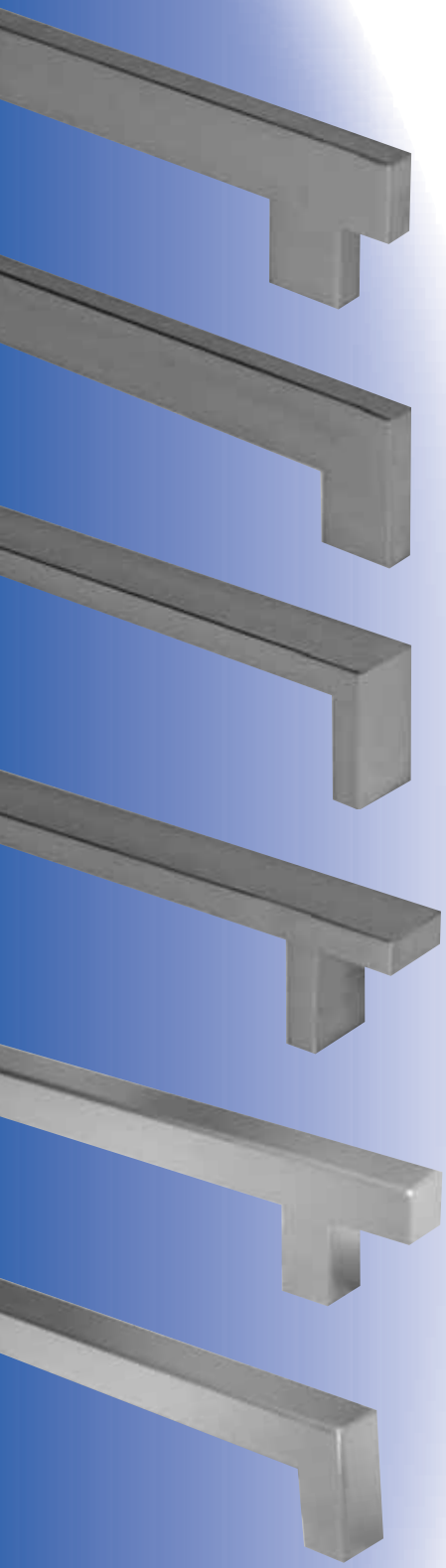

AA6100 Series

Part #	Material	C. to C.
AA6110	3/4" x 1 3/4"	12"
AA6120	3/4" x 1 1/2"	12"
AA6130	1" x 1 1/2"	12"
AA6140	SPECIFY	SPECIFY

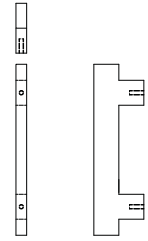

AA6200 Series

Part #	Material	C. to C.
AA6210	3/4" x 1 3/4"	12"
AA6220	3/4" x 1 1/2"	12"
AA6230	1" x 1 1/2"	12"
AA6240	SPECIFY	SPECIFY

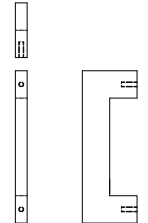

AA6300 Series

Part #	Material	C. to C.
AA6310	3/4" x 1 3/4"	12"
AA6320	3/4" x 1 1/2"	12"
AA6330	1" x 1 1/2"	12"
AA6340	SPECIFY	SPECIFY

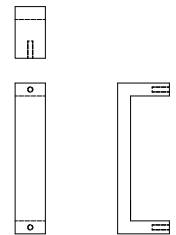

AA6400 Series

Part #	Material	C. to C.
AA6410	3/4" x 1 3/4"	12"
AA6420	3/4" x 1 1/2"	12"
AA6430	1" x 1 1/2"	12"
AA6440	SPECIFY	SPECIFY

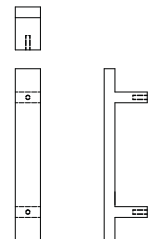

AA6500 Series

Part #	Material	C. to C.
AA6510	3/4" x 3/4"	12"
AA6520	1" x 1"	12"
AA6530	1 1/4" x 1 1/4"	12"
AA6540	SPECIFY	SPECIFY

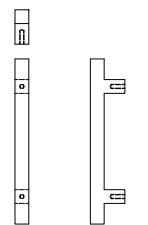

AA6600 Series

Part #	Material	C. to C.
AA6610	3/4" x 3/4"	12"
AA6620	1" x 1"	12"
AA6630	1 1/4" x 1 1/4"	12"
AA6640	SPECIFY	SPECIFY

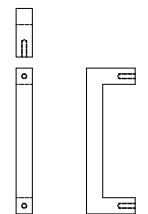

AA6000 series pulls provide a smooth lustrous accent to any entrance. These pulls can be fabricated from both square and rectangular profiles in various sizes, lengths and finishes to meet the architects specification. The popular split finish is also available on all models. Access Architectural Hardware highly recommends that a center mounting post be added to bars 60" on center or greater.



Access Architectural Hardware
 (319) 208-7822 • Fax (319) 208-7708 • www.aahardware.us

CUSTOM ARCHITECTURAL HARDWARE DESIGNS

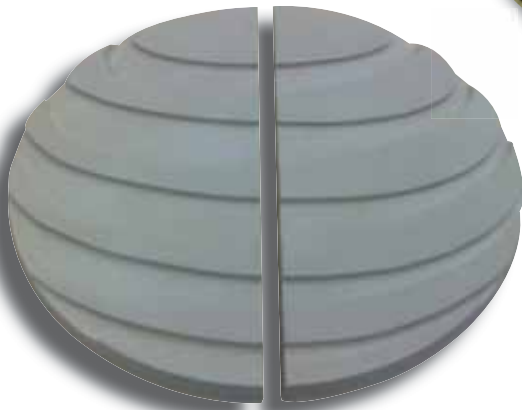

Access Architectural Hardware

(319) 208-7822 • Fax (319) 208-7708 • www.aahardware.us



MOUNTING DETAILS

FINISH GLOSSARY

DESCRIPTIONS

Polished Brass Lacquered
 Polished Brass No Lacquer
 Satin Brass Lacquered
 Satin Brass No Lacquer
 Antique Brass Lacquered
 Polished Bronze Lacquered
 Polished Bronze No Lacquer
 Satin Bronze Lacquered
 Satin Bronze No Lacquer
 Satin Oxidized Bronze
 Bright Chrome Plate
 Satin Chrome Plate
 Satin Clear Anodized Aluminum
 Polished Stainless Steel
 Satin Stainless Steel
 Black Anodized
 Light Bronze - Anodized
 Med. Bronze - Anodized
 Dark Bronze - Anodized
 Duralon Med. Bronze Powder Coat
 Duralon Dark Bronze Powder Coat
 White - Nylon Coat
 Red - Nylon Coat
 Black- Nylon Coat

FINISHES

US3
 US3N
 US4
 US4N
 US5
 US9
 US9N
 US10
 US10N
 US10B
 US26
 US26D
 US28
 US32
 US32D
 DB315
 2S311
 2S312
 2S313
 R312
 R313
 NLW40
 NLR69
 NLB80

BHMA

605
 606
 609
 611
 612
 613
 625
 626
 628
 629
 630

Single mounting *Type 1 MTG*
 on wood or
 metal door

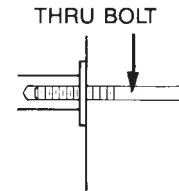

Fastening details
 for metal and
 wood doors

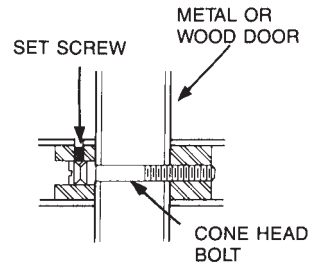

Fastening details
 for glass mounting

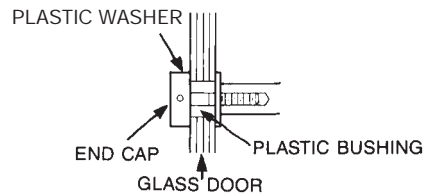

**Back to back
 mounting** *Type 3 MTG*
 on glass

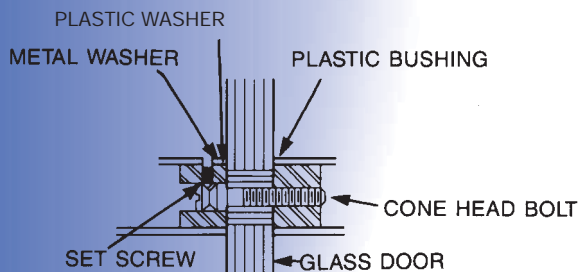

Standard Mounting Details



Single Thru Bolt



Single Concealed

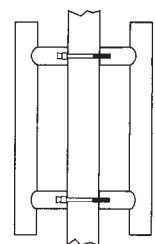

Back to Back

Type 5 MTG



Access Architectural Hardware

(319) 208-7822 • Fax (319) 208-7708 • www.aahardware.us

ORDERING INFORMATION

To ensure prompt delivery please furnish the following information:

1. Part number, finish and quantities
2. Single or back to back mounting
 - A) For back to back mounting on glass, please denote the letter "G" at the beginning of the part number.
 - B) For back to back mounting on wood & metal, denote the letter "S" at the beginning of the part number.
 - C) For concealed mounting on wood or metal door, denote the letter "C" at the end of the part number.
 - D) For single mounting on glass, please denote the letter "G" at the end of the part number.
3. Door type
 - A) Glass door specify thickness of glass and diameter of holes in glass
 - B) Metal and wood doors specify thickness of door and type of mounting
4. Brass and bronze finishes please specify lacquer or no lacquer
5. Hand of door
6. Diameter of material required
7. Center line dimensions of push and or pull bar
8. Access Architectural Hardware highly recommends that a center mounting post be added to bars 60" on center or greater.

FOR MORE INFORMATION CALL **(319) 208-7822**

Access Architectural Hardware

P.O. Box 517

Keokuk, Iowa 52632

www.aahardware.us

Email: info@aahardware.us

Fax: (319) 208-7708

FINISHES:

Access Architectural takes pride in the ability to be able to produce most of our products in a wide variety of architectural finishes. A finish chart is available for reference on page 10. For proper finish maintenance please contact our office.



Split Finish

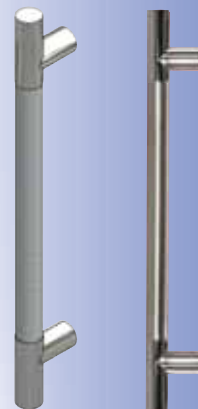

Access Architectural Hardware offers a split finish (brushed and polished) on most architectural push and pull handles. Specify both finishes and the letters "SF" at the beginning of the part number.

Access Architectural Hardware

(319) 208-7822 • Fax (319) 208-7708 • www.aahardware.us

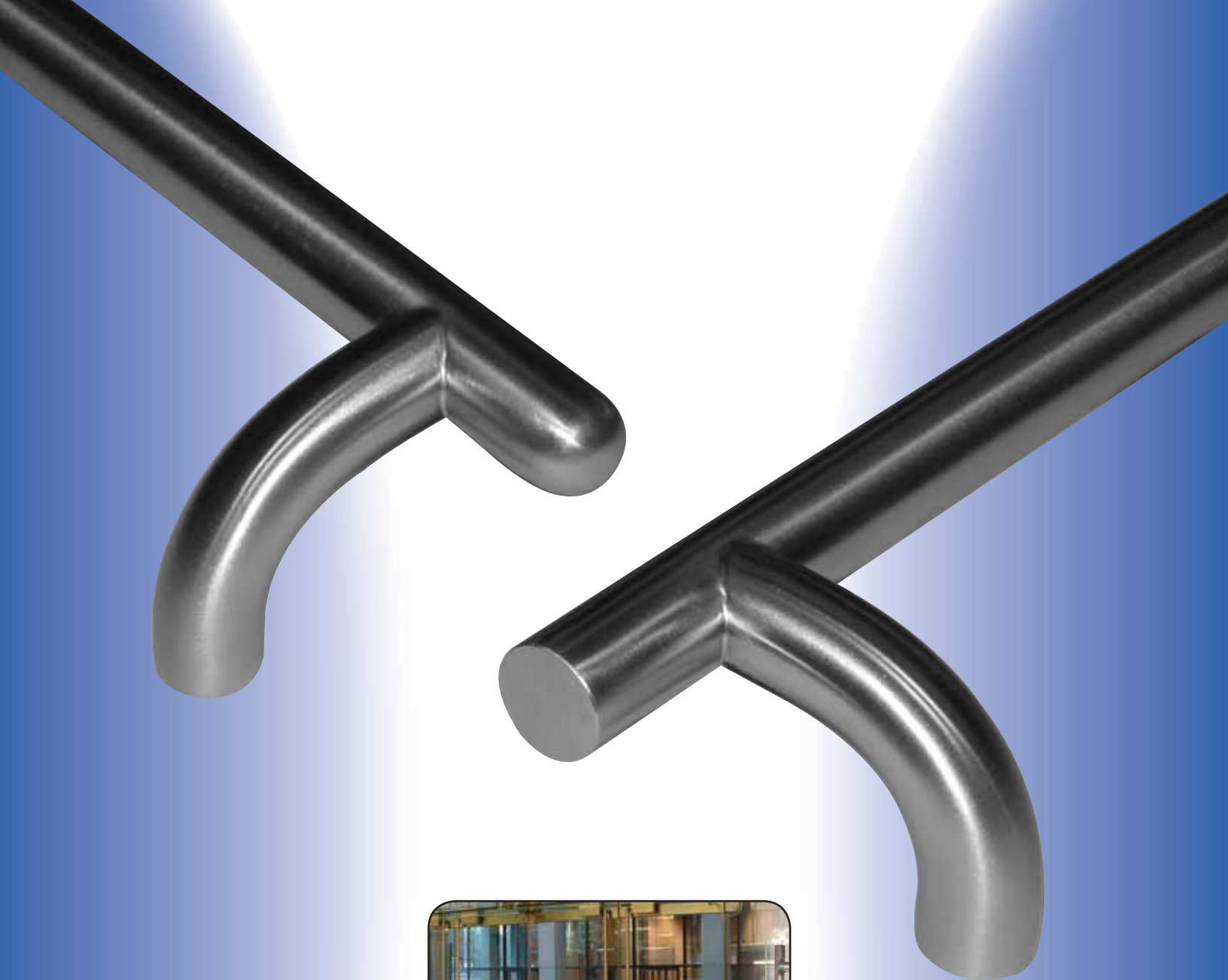

Access Architectural Hardware is a division of Access Door. Access Door is the exclusive manufacturer and distributor of the "Smart Touch" and "Smart Grip" Access Control/Egress Devices. For more information please visit www.accessdoor.us.



Access Architectural Hardware

(319) 208-7822 • Fax (319) 208-7708 • www.aahardware.us